

JackTrack – Aircraft Cable Mount

**IMPORTANT**

- For factory pre-set option, customer to select pattern and provide length of longest pendant. Signoff on Blackjack-generated configuration drawing or designer-supplied submittal drawing required. Pendants are pre-configured by Blackjack per signed submittal drawing. Customized installation instructions are supplied as necessary.
- For field-assembled option, each pendant is provided with standard 8' cable (unless otherwise indicated in system description). Pendants must be cut to desired lengths by installer and attached to track adaptors prior to installation.
- Pendants can be removed from track or cut shorter and reinstalled post-installation.
- Appropriate number of joiners and spacers are included to complete configuration installation.
- Individual runs with pendants can weigh as much as 50 5 pounds per foot. System must be mounted to rigid ceiling material (e.g., sheet rock, fire-rated plywood or similar) that can support system weight.

JackTrack – Aircraft Cable Mount

CAUTION

TURN OFF THE MAIN POWER AT THE CIRCUIT BREAKER BEFORE INSTALLING THE FIXTURE IN ORDER TO PREVENT POSSIBLE SHOCK

IF YOU ARE UNFAMILIAR WITH PROPER ELECTRICAL WIRING CONNECTIONS OBTAIN THE SERVICES OF A QUALIFIED ELECTRICIAN

GENERAL

- Read all instructions carefully for safe operation and installation.
- All electrical connections must be in accordance with local and national electrical code (N.E.C) standards.
- Remove the linear channel(s) and components from their packages and make sure that no parts are missing by referencing the illustrations on the installation instruction. Please contact Blackjack Lighting if any parts are missing or damaged.
- This product is suitable for damp locations.

PREPARE CHANNEL

1. INSTALL ELECTRICAL CONNECTOR

- Attach connector "A" (3) into the end of the track that will attach to end joiner (4). Push connector "A" (3) into channel (5) until the hole in end of the channel aligns with the hole in connector "A". [Please note; connector "A" will only fit correctly into one end of channel (5)]. Insert flat head screw (6) into connector "A" (3) and into the threaded hole in channel (5). Tighten screw (6) part way but not completely so it does not protrude through the back of channel (5).

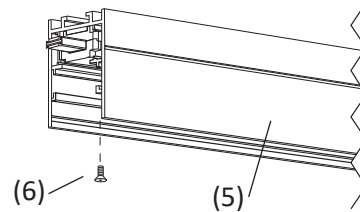
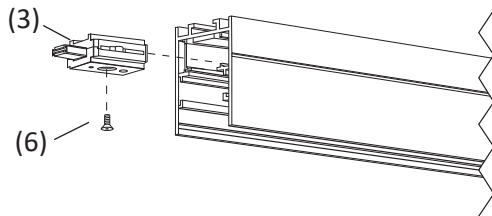

2. INSTALL END JOINER

- Loosen both set screws (7) from the tongue of end joiner (4). Slide end joiner (4) into channel (5) until it makes firm contact. While keeping this firmly in contact, tighten both set screws (7). Turn the channel over and tighten flat head screw (6) until connector "A" (3) is firmly held in place.
- Install the strain relief collar (46) onto the end joiner (4) by threading the low voltage cable (41) through the center mounting hole. Tighten the fastener firmly into the back of the end joiner (4) and tighten the side set screw to hold the electrical cable (41) in place.

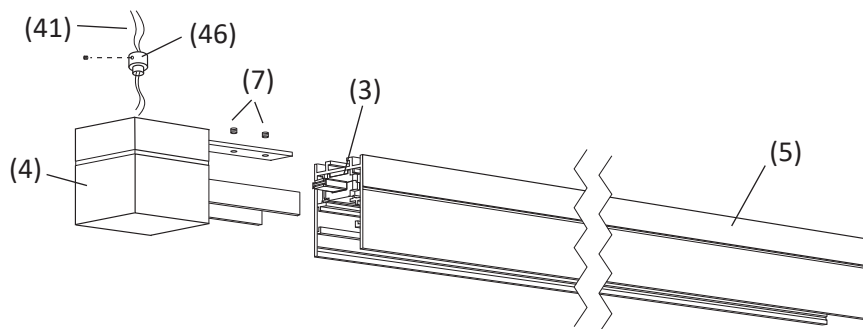

3. INSTALL AIRCRAFT CABLE MOUNTING BRACKET

a. Determine the total number of mounting brackets (26) that are required for each channel (5):

1. A 23" to 47" length of channel (5) will require at least two mounting brackets (26).
 2. Lengths greater than 47" and up to 94" will require at least three mounting brackets (26).
- When installed in a continuous row, each individual section of not more than 48" in length shall have at least one additional mounting bracket (26).

b. Mount first bracket for aircraft cable:

Install mounting bracket (26) into channel (5) and slide it as close as possible to end joiner (4). Attach aircraft cable assembly; pull the aircraft cable (43) through the ball end support collar (44) until the ball end rests inside the collar. Insert aircraft cable (43) into aircraft cable gripper (42). Attach locking ring (45) onto the end of the aircraft cable gripper (42), then attach it to mounting bracket (26). Tighten all the way down, then tighten locking ring (45) to secure it into the bracket (26). Lock bracket (26) in place with set screw (21).

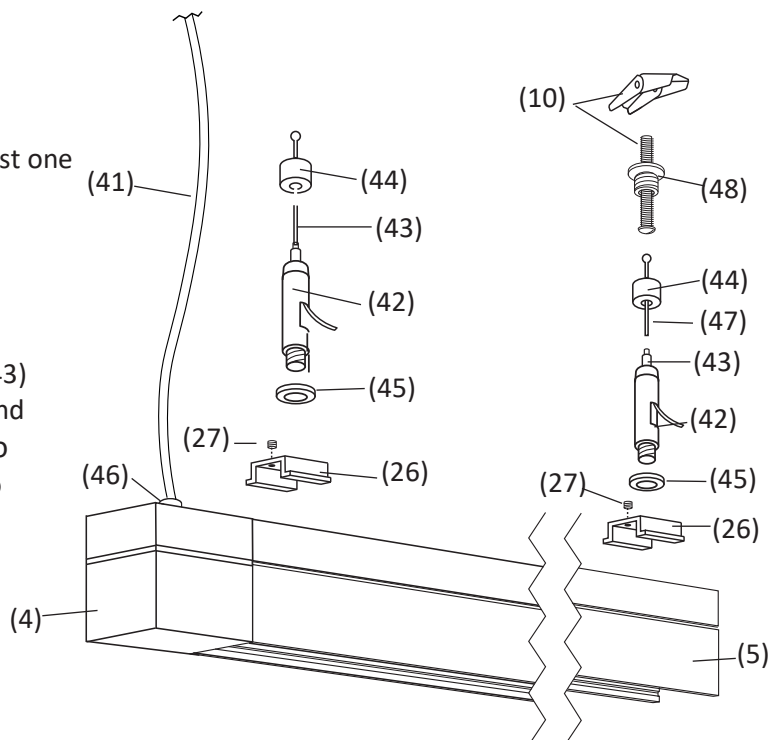

c. Mount additional brackets for aircraft cable:

Additional brackets (26) may be required to be slid in the back of the channel (5) to support additional aircraft cables. Attach Aircraft cable assembly to mounting bracket (26) as outlined above (in 3b)

4A (OPTION 1) PREPARE OPPOSITE END FOR SINGLE CHANNEL INSTALLATIONS

- For single channel installations install the decorative endcap: (13) by sliding the endcap into the channel (5) and inserting a 5/16" flat head screw (24) into the base of the endcap and through the hole at the end of the channel (5).

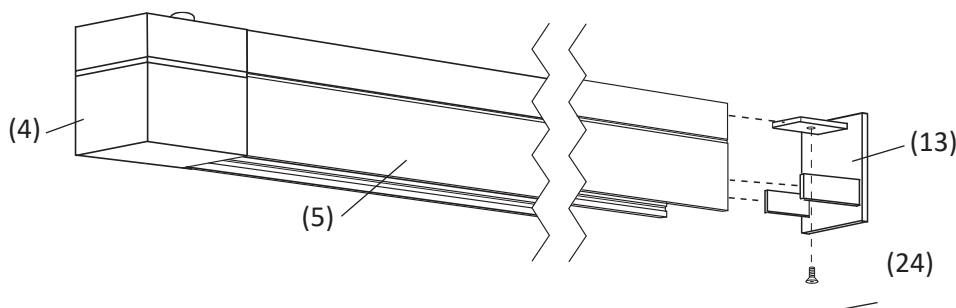

4B (OPTION 2) PREPARE OPPOSITE CHANNEL END FOR EXTERNAL JOINER CONNECTION

- For connection to additional channel sections (5) with an external joiner either ("L"/ "I"/ "T"/ "X" Joiner) (15):

- a. INSTALL CONNECTOR: Attach connector "B" (14) into the end of the track that will attach to the external joiner (15). Push connector "B" (14) into the channel (5) until the hole in end of the channel aligns with the hole in connector "B". [Please note; connector "B" will only fit correctly into one end of the channel (5)]. Insert a flat head screw (6) into connector "B" and into the threaded hole in Channel (5). Tighten screw (6) part way but not completely so it does not protrude through the back of the channel (5).

- b. **INSTALL JOINER:** Loosen both set screws (7) from the tongue of the external joiner (15). Slide the external joiner (15) into the channel (5) until it makes firm contact. While keeping the joiner (15) firmly in contact, tighten both of the set screws (7). Turn the channel over and tighten the flat head screw (6) until connector “B” (14) is firmly held in place.

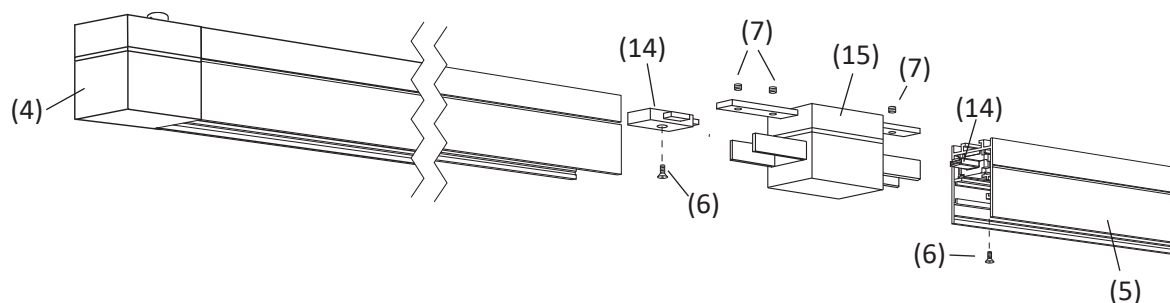

4C (OPTION 3) PREPARE OPPOSITE CHANNEL END FOR INTERNAL JOINER CONNECTION

- For connection to additional channel sections (5) with an internal joiner (16)

- a. **INSTALL CONNECTOR:** Attach one end of double connector “C” (17) into the end of the track that will attach to the internal joiner (16). Push double connector “C” (17) into the channel (5) until the hole in the end of channel aligns with the hole in one end of double connector “C”. [Please note; connector “C” will only fit correctly into one end of the channel (5)]. Insert a flat head screw (6) into connector “C” (17) and into the threaded hole in Channel (5). Tighten part way but not completely so that the screw does not protrude through the back of the channel.
- b. **INSTALL JOINER:** Slide one top and two side pieces of the internal joiner (16) into the channel (5) and position it with half of the length of each of the three pieces of internal joiner (16) extending out from the end of the channel (5). Tighten the screws from the top piece and the two side pieces of the internal joiner (16) until it mounts firmly in place in the channel (5). Turn the channel over and tighten the flat head screws (6) until connector “C” (17) is firmly held in place.

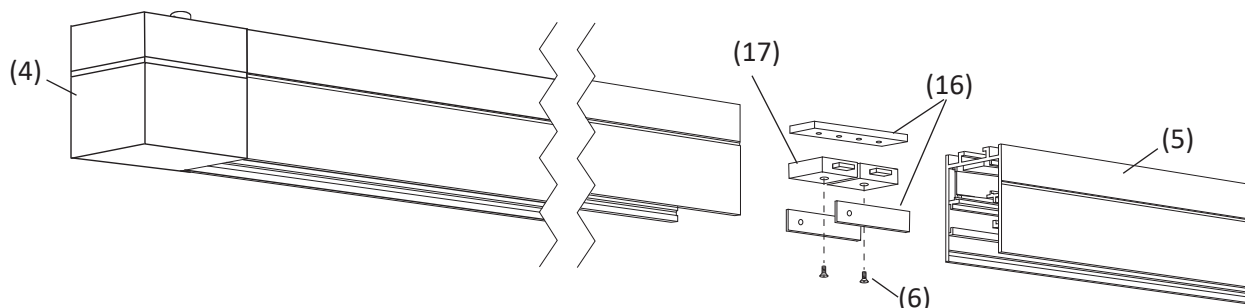

5. INSTALL BACKPLATE TO JUNCTION BOX

- a. Install the backplate (1, 9, 20 or 21) to the junction box (21).
- b. **For the junction box cover plate (1):** pull the two electrical low voltage wires (22) from remote driver (50) through backplate. Install cover plate (1) so that side mounted screw hole is facing the same direction as the channel (5)
- c. **For the round and rectangular canopies:** pull the line voltage supply wires (51) from junction box (12) through the backplate. Attach line voltage supply wires (51) to input wires from driver (40)

6. INSTALL AIRCRAFT CABLE / ELECTRICAL WIRE ASSEMBLY TO CANOPY COVER

- a. Pull the aircraft cable (43) through the ball end support collar (44) until the ball end rest inside the collar. Attach it to the center of the canopy, and secure it with the threaded hex fastener (23) from the inside of the ceiling canopy.
- b. Pull the length of the aircraft cable (43) through the gripper (42) until the approximate channel mounting height is achieved. Final cable length to be determined once the track is mounted to the ceiling.
- c. Insert the low voltage cable (41) from the end joiner (4) through the strain relief collar (46) and into the ceiling canopy (29, 35, 38, or 32)
- d. Determine the approximate length of electrical cable (41) (it is recommended to allow the electrical cable to have some slack once installed). Temporarily tighten the set screw on the strain relief collar (46) attached to the canopy. Cut the excess cable (41) on the inside of canopy (leaving some extra length for later adjustment) or wrap excess wire around bracket (53) on canopy (29) or bracket (54) on canopy (35).

7. INSTALL AIRCRAFT CABLE CEILING SUPPORTS

- a. Measure the distance between the first mounting bracket (26) (underneath the center of the canopy) and the next mounting bracket (26). Then measure the distance between each of the remaining mounting brackets (26) along the channel (5). Mark the distance between the canopy center and the first mounting bracket on the ceiling. Then mark the rest of the measured bracket locations in a straight line on the ceiling.
- b. Unscrew the aircraft cable ball end support (47) attached to the ceiling mount bracket (48). Align the ceiling mount bracket with the marks made on the ceiling and mark the center hole location on the ceiling.
- c. Insert a ceiling anchor (10) rated to support at least 40 pounds to the ceiling mount location (anchor and fastener not included). It is recommended to use a No. 10 (3/16" dia.) toggle bolt ceiling anchor (in sheetrock applications) or a No. 10 round head screw (3/16" dia.) into a solid surface. Tighten the ceiling mount bracket (48) until it rests firmly against the ceiling.

8. CONNECT ELECTRICITY

Attach the low voltage fixture wires (41) coming from the end joiner (4) through ceiling canopy (29, 35, 32, or 38) to the low voltage wire (34) coming from integrally mounted driver (50) using quick connector (52). Low voltage fixture wires can also be attached to the low voltage wires (22) coming through the junction box (12) from remote mounted driver (50).

[NOTE: DO NOT CONNECT THE LOW VOLTAGE (24v) ELECTRICAL WIRING (41) COMING FROM THE END JOINER (4) TO A LINE VOLTAGE (120-277v) INPUT FROM THE JUNCTION BOX (12)]

9. ATTACH CEILING CANOPY

- a. **For junction box cover plate** (29); align cover (29) to side openings in backplate (1) Attach with a quarter turn motion. Lock the front cover (29) to the backplate (1) by inserting the side mounted backplate screw (2)
- b. **For shallow canopy** (35); Attach driver (50) and its rear disk to the support bracket (54) with two screws (55). Push the front canopy (35) up to the canopy backplate (32) until the canopy is firmly positioned against the ceiling, and then lock into position with three side finials (49)
- c. **For deep canopy** (38); Secure the internal support bracket (37) to the canopy backplate (37) with the two finials (36) on either side. Then install the two finials (39) holding the deep round cover plate (38) to the mounting bracket (37)
- d. **For rectangular canopy** (32); Attach the canopy cover (32) and secure it to the canopy backplate (21) with the four screws (19).

10. ATTACH AIRCRAFT CABLE TO CEILING SUPPORTS

- a. Mount each aircraft cable ball end support (47) to the ceiling mount bracket (48) and hand fasten them together.
- b. Adjust the length of each aircraft cable (43) to achieve a horizontally mounted channel (5). To raise the channel, pull the cable (43) through the gripper (42), or push down the top of the gripper to release more cable to lower the channel (5)
- c. Once all of the aircraft cable wires are adjusted to the proper length take a cable cutting pliers and cut the excess aircraft cable (43) coming out the side of the gripper (42).

(Remote Driver)

(20W or 40W Driver)

(60W or 96W Driver)

(200-300W Driver)

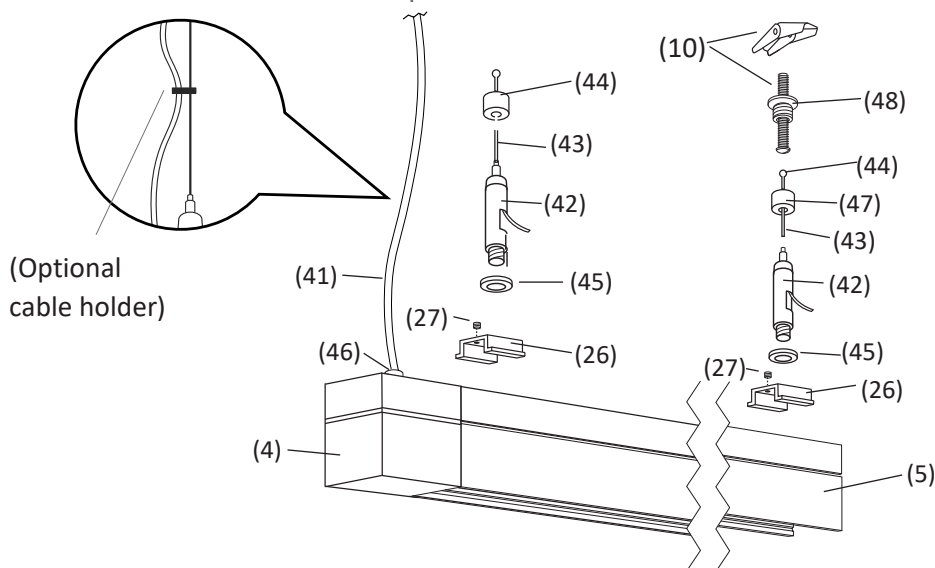
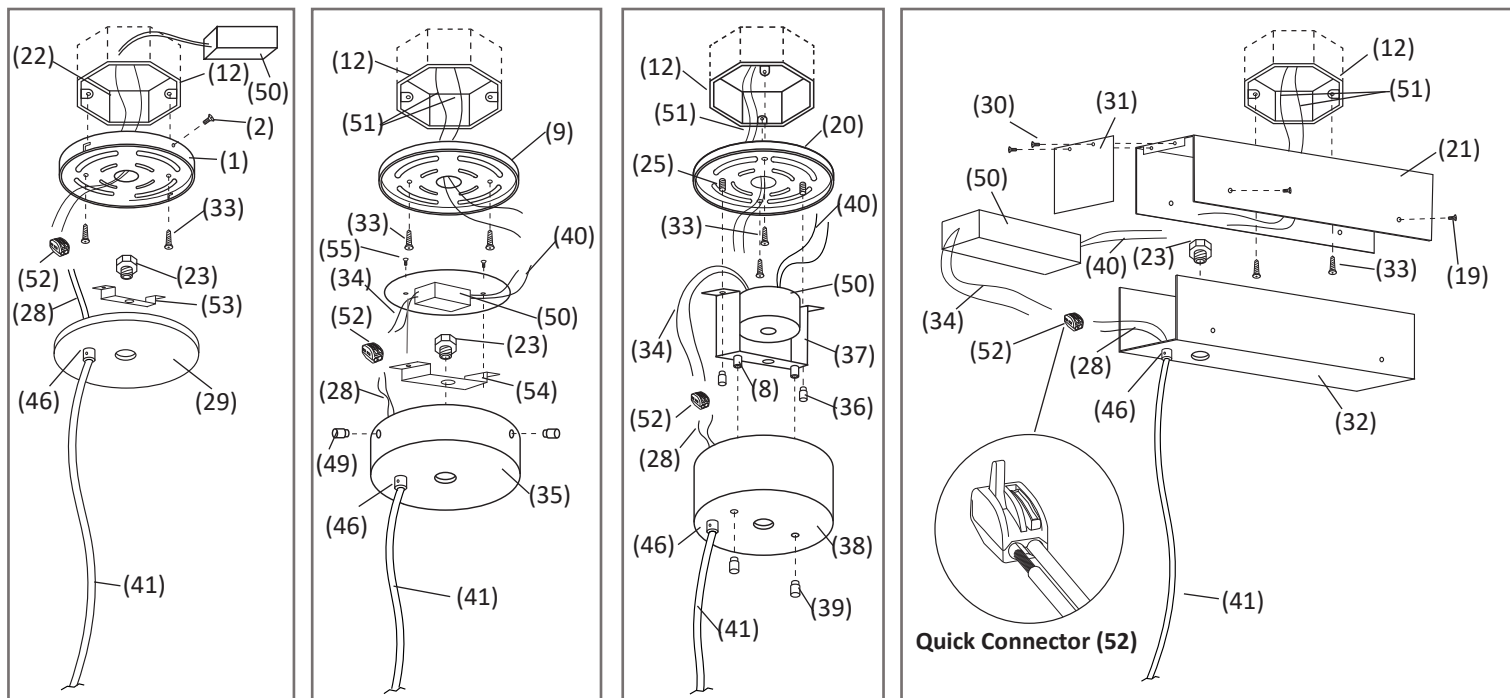

- | | | |
|---------------------------------------|--|---|
| 1. JUNCTION BOX COVER BACKPLATE | 20. DEEP ROUND CANOPY BACKPLATE | 38. DEEP ROUND CANOPY COVER |
| 2. JUNCTION BOX COVER BACKPLATE SCREW | 21. RECTANGULAR CANOPY BACKPLATE | 39. DEEP ROUND CANOPY DECORATIVE FINIALS |
| 3. CONNECTOR "A" | 22. LOW VOLTAGE WIRES FROM REMOTE DRIVER | 40. LINE VOLTAGE WIRE FROM DRIVER |
| 4. END JOINER | 23. THREADED HEX FASTENER | 41. ELECTRICAL CABLE |
| 5. CHANNEL | 24. END CAP FLAT HEAD SCREW | 42. GRIPPER |
| 6. FLAT HEAD SCREW | 25. DEEP ROUND CANOPY THREADED POSTS | 43. AIRCRAFT CABLE |
| 7. JOINER SET SCREWS | 26. MOUNTING BRACKET | 44. SPECIAL CANOPY MOUNT BRACKET |
| 8. INTERNAL SUPPORT THREADED POSTS | 27. SET SCREW | 45. LOCKING RING |
| 9. SHALLOW CANOPY BACKPLATE | 28. LINE VOLTAGE WIRES FROM END JOINER | 46. END JOINER STRAIN RELIEF COLLAR |
| 10. CEILING ANCHOR (by others) | 29. JUNCTION BOX COVER PLATE | 47. CEILING MOUNT BRACKET |
| 11. DEEP ROUND CANOPY THREADED POSTS | 30. RECTANGULAR CANOPY END COVER SCREWS | 48. SUPPORT ASSEMBLY CEILING MOUNT BRACKET |
| 12. JUNCTION BOX | 31. RECTANGULAR CANOPY END COVER | 49. SHALLOW CANOPY DECORATIVE FINIALS |
| 13. DECORATIVE ENDCAP | 32. RECTANGULAR CANOPY COVER | 50. DRIVER |
| 14. CONNECTOR "B" | 33. MOUNTING SCREWS | 51. LINE VOLTAGE SUPPLY WIRES FROM JUNCTION BOX |
| 15. EXTERNAL JOINER | 34. LOW VOLTAGE WIRES FROM DRIVER | 52. QUICK CONNECTOR |
| 16. INTERNAL JOINER | 35. SHALLOW ROUND CANOPY COVER | 53. JUNCTION BOX COVER PLATE U-BRACKET |
| 17. DOUBLE ENDED CONNECTOR "C" | 36. INTERNAL SUPPORT FINIALS | 54. SHALLOW CANOPY U-BRACKET |
| 18. LOW VOLTAGE CABLE FIXTURE WIRES | 37. INTERNAL SUPPORT MOUNTING BRACKET | 55. SHALLOW CANOPY U-BRACKET SCREW |
| 19. RECTANGULAR CANOPY SCREWS | | |