

Duo Modular System

MD-38xx (38" / 10 or 18 Port)

**IMPORTANT**

- For factory pre-set option, customer to select pattern and provide distance of longest pendant. Signoff on Blackjack-generated configuration drawing or designer-supplied submittal drawing required. Pendants are pre-installed and pre-configured by Blackjack per signed submittal drawing. Customized installation instructions are supplied as necessary.
- For customer-set (DIY) option, pendants are installed in canopies with approximately 6' cable exposed. Customer to connect canopies and make adjustments to cable length in-field as desired.
- Standard 8' total of field-adjustable cable is included with each pendant (unless otherwise specified); no cutting or splicing required should adjustments need to be made in the field.
- Appropriate number of joiners and spacers included to complete configuration installation.
- Individual canopies with pendants can weigh as much as 50 pounds. Canopies and system must be mounted to rigid ceiling material (e.g., sheet rock, fire-rated plywood or similar) that can support system weight and accept drywall anchors, expandable fasteners or similar structural fasteners.

Duo Modular System

MD-38xx (38" / 10 or 18 Port)

CAUTION

TURN OFF THE MAIN POWER AT THE CIRCUIT BREAKER BEFORE INSTALLING THE FIXTURE IN ORDER TO PREVENT POSSIBLE SHOCK

IF YOU ARE UNFAMILIAR WITH PROPER ELECTRICAL WIRING CONNECTIONS OBTAIN THE SERVICES OF A QUALIFIED ELECTRICIAN

GENERAL

- Read all instructions carefully for safe operation and installation.
- All electrical connections must be in accordance with local and national electrical code (N.E.C) standards.
- Remove the fixture from its box and make sure that no parts are missing by referencing the illustrations on the installation instruction. Please contact Blackjack Lighting if any parts are missing or damaged.
- This product is suitable for damp locations.

INSTALLATION

PREPARATION

1. Remove the fixture from its box. Carefully unpack the bundled wire packages. Be careful not to bend or kink the wires when unpacking them. Remove the additional package with the selected decorative light guide assemblies (17 & 18).
2. Remove the ceiling plate (9) from the canopy cover (10) by loosening and removing the four decorative nuts (11).

MOUNTING

3. This fixture must be mounted to a rigid mounting surface (sheet rock, fire rated plywood or similar). Before final installation align all the orientation arrows, located inside the fixture, to face the same direction. Place the ceiling plate (9) over the outlet box (1) and mark where to drill for the two support holes. Drill the two support holes using the appropriately sized drill bit. Insert the provided ceiling anchors (12) into the holes. Align the first ceiling plate (9) mounting holes with the support holes/ceiling anchors (12), then screw the anchor screws (13) halfway into the ceiling anchors (12). Attach the ceiling plate (9) to the outlet box (1) using the two mounting screws (8). When the ceiling plate (9) is properly aligned in the installation fully tighten all the anchor screws (13).
4. Pull the supply wires (2&3) and the house ground wire (4) out of the outlet box (1) and thread them through the large center hole in the ceiling plate (9). If this fixture will be attached to a 0-10V dimmer (optional) also pull the two 0-10V dimming wires (5 & 6) through the large center hole.

INSTALL SPACERS AND JOINERS

5. For runs that will use fixture spacers (19) and a joiner kit (22), install the female side of the fixture spacers to attach to the joining side of the first ceiling plate (9). Insert the two male screws (20) from inside the housing and tighten them securely into the spacer (19) (see figure 1).
6. Push out the large center knock-out from the first ceiling plate (9) mating side. Remove the knurled ring (23) from the joiner (22) and insert the end of the joiner (22) into the knock-out opening. Re-tighten the knurled ring (23) onto the side of the joiner (22) that is now inserted into the canopy. (see figure 1).

Figure 1

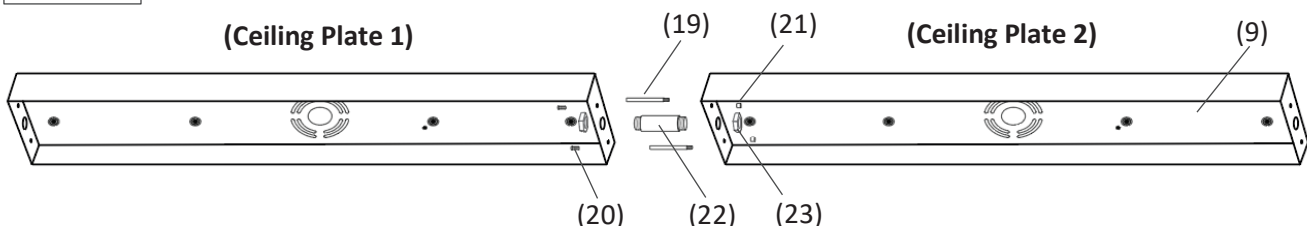

7. Push out the large center knock-out from the second ceiling plate (9). Install the second ceiling plate into the side with the fixture spacers (19) and the joiner kit (22). Insert the fixture until it is securely aligned by the threaded rods of fixture spacers. Mark the hole locations for the two mounting holes. Drill two support holes using the appropriately sized drill bit. Insert the provided ceiling anchors (12) into the holes. First fasten the anchor screws (13) halfway into the ceiling anchors (12); when properly aligned with the adjacent ceiling plate (9), fully tighten all anchor screws (13). Place the knurled ring (23) over the end of the joiner (22) and hex nuts (21) over the exposed thread on the fixture spacers (19), and tighten. Feed the three conductor 36" extension wire (25) and (Optional) Dimming Purple and Grey 36" extension wires (26) through the joiner tube (22) into the second fixture. (See Figures 2 and 3)

ELECTRICAL CONNECTIONS

8. Remove the female three conductor connector (27) from the male connector (28) attached to the driver. Attach this female three conductor connector (27) to the input supply/ ground wires. Attach the black supply wire to one of the two black poke-in terminals in the back of the female three conductor connector (27). Attach the black wire from the 36" three conductor extension wire (25) to the other black poke-in terminal. Attach the white supply wire to one of the two white poke-in terminals in the back of the female three conductor connector (27). Attach the white wire from the 36" three conductor extension wire (25) to the other white poke-in terminal. Attach the ground wire to one of the two red poke-in terminals in the back of the female three conductor connector (27). Attach the green wire from the 36" three conductor extension wire (25) to the other red poke-in terminal. (See Figures 2 and 3)
9. If this fixture will be attached to a 0-10V dimmer(optional): Remove the female two conductor connector (29) from the male two connector (30) attached to driver. Attach this female two conductor connector (29) to the dimming input wires. Attach the purple (or "+" /positive) dimming input wire to one of the white poke-in terminals on the back of the two conductor connector (29). Attach the Purple 36" extension wire (26) to the other white poke-in terminal. Attach the gray (or "-" /negative) dimming input wire to one of the black poke-in terminals on the back of the two conductor connector (29). Attach the Grey 36" extension wire (26) to the other black poke-in terminal. (See Figures 2 and 3)

Repeat steps 5 – 9 for additional canopies.

Figure 2

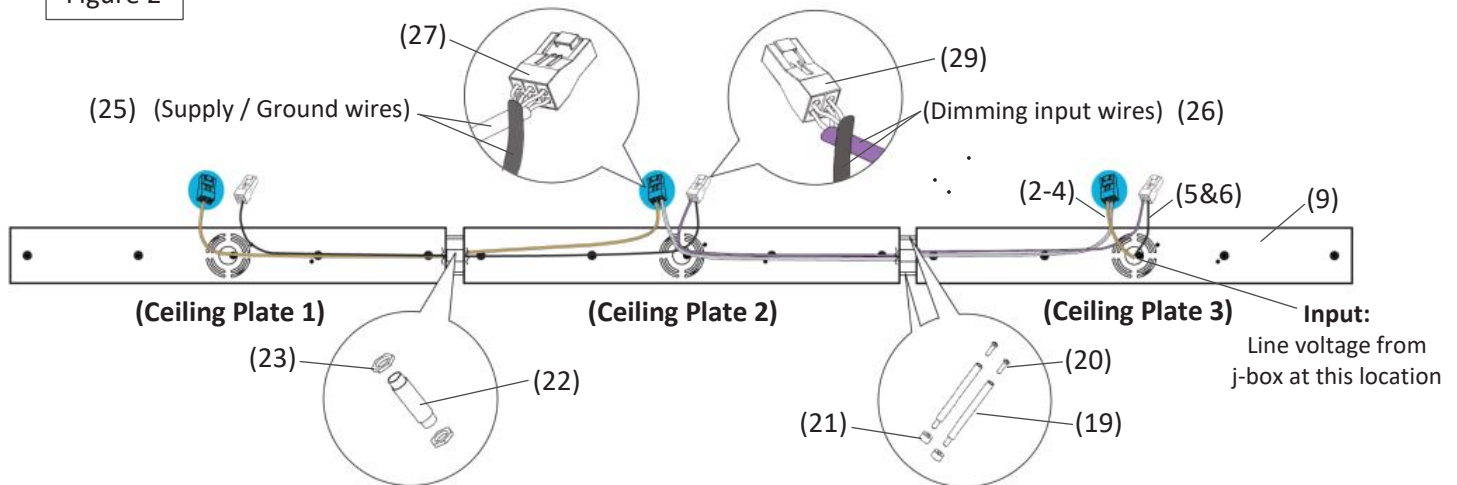

FINAL ASSEMBLY

10. Determine the appropriate length of each suspension cable (if in doubt about exact length needed, leave a little extra cable until the final installation of the canopy cover (10)). Push the excess cable up into the canopy by pressing the small barrel of the gripper (16) upward. This will release the cable tension and allow the suspended cable to be pulled through gripper (16). Roll the excess cable into a small loop inside of the canopy. Wrap the supplied Velcro strap around the loop to keep the excess cable from falling outside of the canopy (10).
11. Temporarily suspend the canopy cover (10) from the ceiling plate (9) by attaching the two support loops (15) to the mating hooks (14) (secured in the ceiling plate (9)).
12. Connect the three-conductor female connector (27) attached to the ceiling plate (9) to the three-conductor male connector (28) attached to the driver (24). (optional) Connect the two-conductor female dimming connector (29) attached to the ceiling plate (9) to the two-conductor male connector (30) attached to the driver (24). (See Figure 3)

13. To assemble the light guides simply screw the diffuser (18) into the light guide socket (17).
14. Make sure all the cables are carefully placed inside canopy cover (10). To secure the canopy cover (10) to the ceiling plate (9) align the holes in the cover (10) over the outward screws (7) then tighten the four decorative nuts (11) over the outward screws (7) .
15. Once the canopy is in place, use the gripper (16) to fine tune the wire lengths until each light guide (17 & 18) is adjusted to its preferred length.
16. Once the length of each cable has been established, any remaining bends or kinks in the wire can be straightened by bending out the kinks by hand while heating the cord up with the warm air from a hair dryer or heat gun. Or contact BlackJack Lighting for a handheld wire straightener.

Figure 3

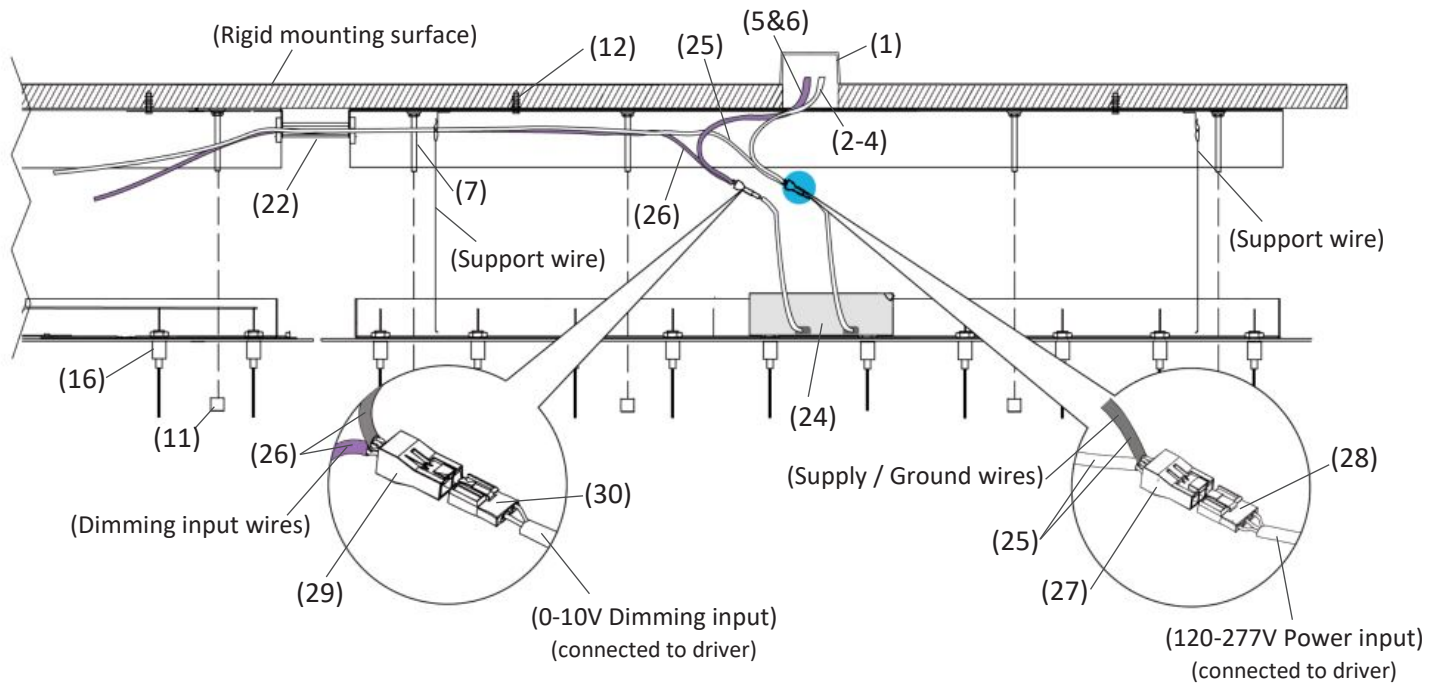

DIMMING

- Fixture Dimming Type: TRIAC, ELV, or 0-10V dimmable.
- For recommended dimmers see <https://www.blackjacklighting.com/dimming-information>

HARDWARE PER FIXTURE



Mounting Screws (#8)
[2 Included]



Decorative Nut (#11)
[4 Included]



Ceiling Anchor (#12)
[2 Included]



Anchor Screw (#13)
[2 Included]

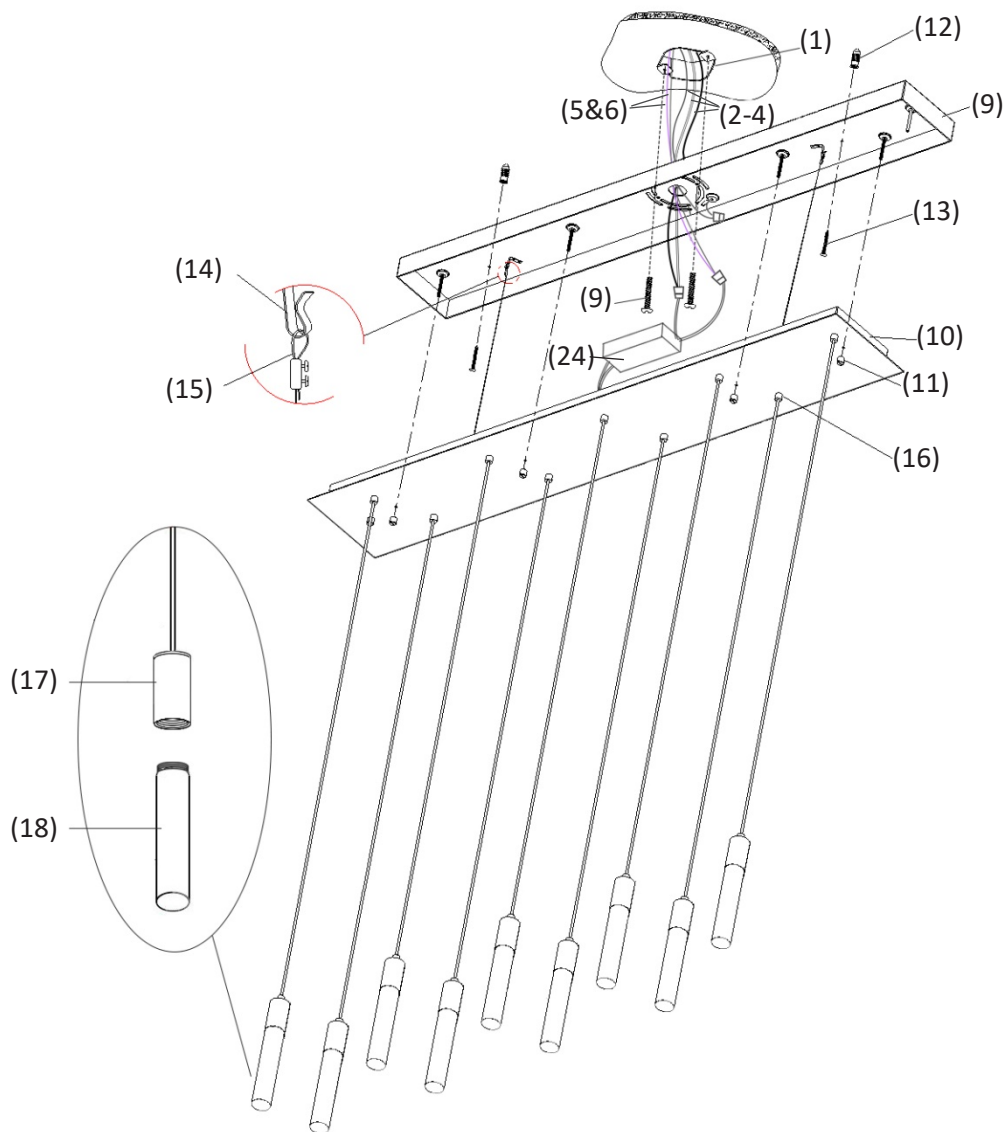

- | | |
|------------------------------|--|
| 1. OUTLET BOX (by others) | 17. SOCKET |
| 2. WHITE SUPPLY WIRE | 18. LIGHT GUIDE DIFFUSER |
| 3. BLACK SUPPLY WIRE | 19. SPACER |
| 4. HOUSE GROUND WIRE | 20. MALE SPACER SCREW |
| 5. GREY 0-10V DIMMING WIRE | 21. SPACER HEX NUT |
| 6. PURPLE 0-10V DIMMING WIRE | 22. JOINER KIT |
| 7. OUTWARD SCREWS | 23. KNURLED RING |
| 8. MOUNTING SCREWS | 24. DRIVER |
| 9. CEILING PLATE | 25. 3 CONDUCTOR 36" EXTENSION WIRE |
| 10. CANOPY COVER | 26. 2 CONDUCTOR PURPLE AND GREY 36" EXTENSION WIRE
(Optional Dimming) |
| 11. DECORATIVE NUT | 27. 3 CONDUCTOR FEMALE CONNECTOR |
| 12. CEILING ANCHOR | 28. 3 CONDUCTOR MALE CONNECTOR |
| 13. ANCHOR SCREW | 29. 2 CONDUCTOR FEMALE CONNECTOR (Optional Dimming) |
| 14. HOOK | 30. 2 CONDUCTOR MALE CONNECTOR (Optional Dimming) |
| 15. LOOP | |
| 16. GRIPPER | |