

C-MCR-2003/12-PC/BL/WH-27U

20" Round / 3-Port

CAUTION

TURN OFF THE MAIN POWER AT THE CIRCUIT
BREAKER BEFORE INSTALLING THE FIXTURE IN
ORDER TO PREVENT POSSIBLE SHOCK

IF YOU ARE UNFAMILIAR WITH PROPER
ELECTRICAL WIRING CONNECTIONS OBTAIN THE
SERVICES OF A QUALIFIED ELECTRICIAN

GENERAL

- Read all instructions carefully for safe operation and installation.
- All electrical connections must be in accordance with local and national electrical code (N.E.C) standards.
- Remove the fixture and the mounting package from the box and make sure that no parts are missing by referencing the illustrations on the installation instruction. Please contact Blackjack Lighting if any parts are missing or damaged.
- This product is suitable for damp locations.

INSTALLATION**PREPERATION**

1. Carefully remove the fixture and the 3 light guide assemblies (18-21) from the box. Be careful not to bend the wires.
2. Remove the ceiling plate (10) from the canopy cover (11) by loosening the three decorative finials (12).
3. Place the ceiling plate (10) over the outlet box (1). Drill six support holes using the appropriately sized drill bit. Insert the provided ceiling anchors (16) into the holes. First screw the anchor screws (17) halfway into the ceiling anchors, then further attach ceiling plate (10) to the outlet box (1) by using two mounting screws (9). Afterward fully tighten all anchor screws (17).
4. Pull the supply wires (2 & 4) and the house ground wire (6) out of the outlet box (1) and thread them through the large center hole in ceiling plate (10)
5. Temporarily suspend canopy cover (11) from ceiling plate (10) by attaching loop (14) to mating hooks (13).

ELECTRICAL CONNECTIONS

6. Using the wire connectors (8), connect the white supply wire (2) to the white fixture wire (3); connect the black supply wire (4) to the black fixture wire (5); and connect the house ground wire (6) to the fixture ground wire (7) .

MOUNTING

7. Once all the wires are connected carefully wind them up and secure with the included twist ties. Then carefully place the wires back into the outlet box (1).
8. To install the light guides (20) simply screw the light guides (20) into the sockets (19).

FINAL ASSEMBLY

9. Adjust the pendant cable (21) to the desired length (if in doubt about exact length needed, leave a little extra cable until the final installation of the canopy cover (11)). Push the excess cable (21) up into the canopy by pressing the small barrel of the gripper (15) upward. This will release the cable tension and allow the suspended cable to be pulled through gripper (15). Wind the excess cable (21) up into a small loop inside the canopy. Wrap the supplied Velcro strap around this loop to keep the excess cable from falling outside of the canopy.
10. Make sure all wires are carefully placed inside canopy. Secure the canopy cover (11) to the ceiling plate (10) by tightening the three decorative finials (12).
11. Once the canopy is in place, fine tune the cable (21) lengths longer or shorter to get each pendant adjusted to its preferred length by adjusting the gripper (15). Once the length of each wire has been established, any remaining bends or kinks in the cable can be straightened by bending out the kinks by hand while heating the cord up with the warm air from a hair dryer or heat gun.

DIMMING

- Fixture Dimming Type: TRIAC or ELV dimming.
- For recommended dimmers see <https://www.blackjacklighting.com/dimming-information>

HARDWARE

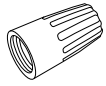

Wire Connector (#8)
[3 Included]



Mounting Screws (#9)
[2 Included]



Decorative Finial (#12)
[3 Included]



Anchor (#16)
[6 Included]



Anchor Screw (#17)
[6 Included]

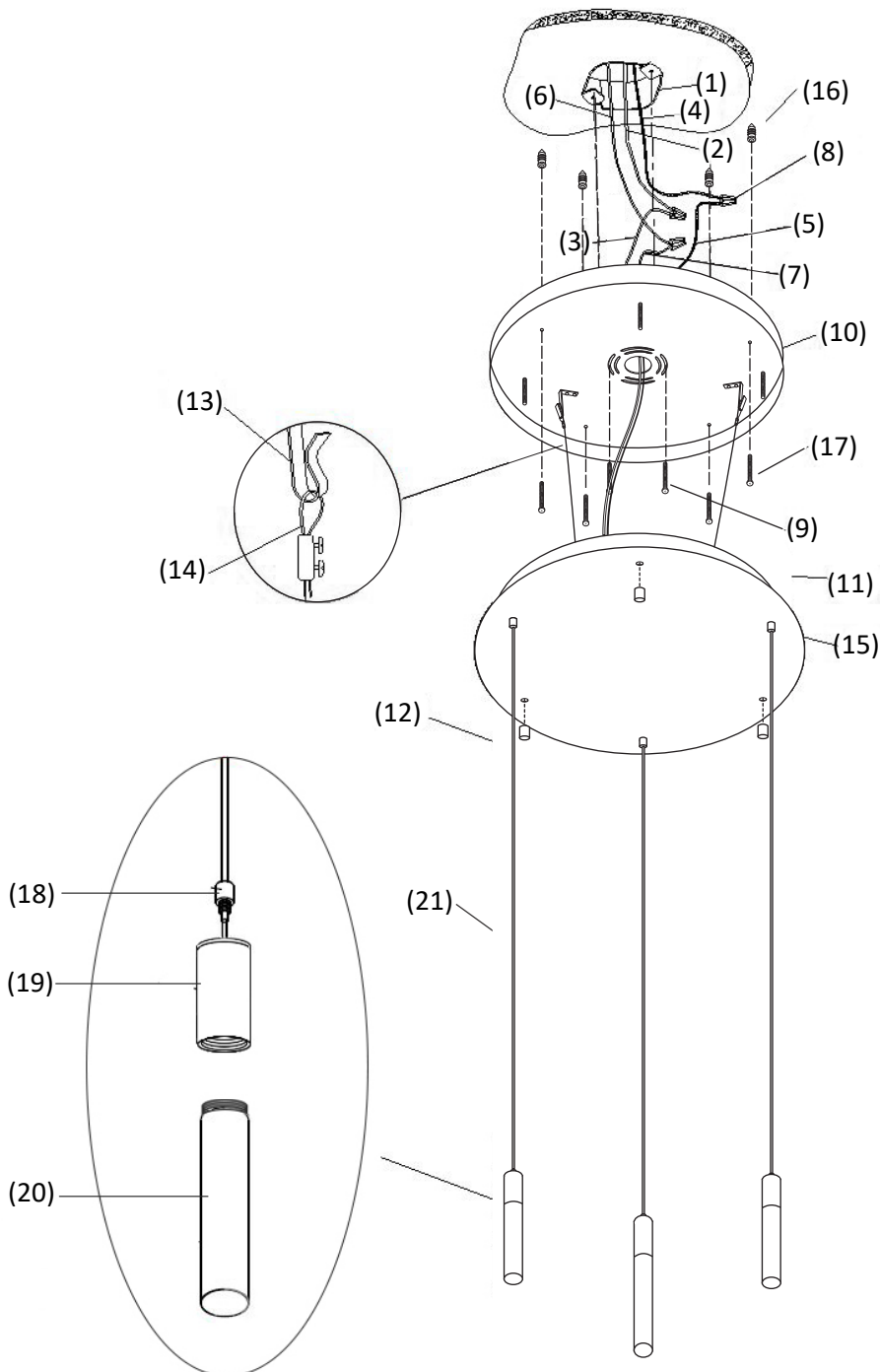

1. OUTLET BOX (By Others)
2. WHITE SUPPLY WIRE
3. WHITE FIXTURE WIRE
4. BLACK SUPPLY WIRE
5. BLACK FIXTURE WIRE
6. HOUSE GROUND WIRE
7. FIXTURE GROUND WIRE
8. WIRE CONNECTOR
9. MOUNTING SCREWS
10. CEILING PLATE
11. CANOPY COVER
12. DECORATIVE FINIAL
13. HOOK
14. LOOP
15. GRIPPER
16. ANCHOR
17. ANCHOR SCREW
18. PENDANT GRIPPER
19. SOCKET
20. LIGHT GUIDE
21. PENDANT CABLE