

BULLET PENDANT

MBL()-04P (4")

CAUTION

TURN OFF THE MAIN POWER AT THE CIRCUIT BREAKER BEFORE INSTALLING THE FIXTURE IN ORDER TO PREVENT POSSIBLE SHOCK

IF YOU ARE UNFAMILIAR WITH PROPER ELECTRICAL WIRING CONNECTIONS OBTAIN THE SERVICES OF A QUALIFIED ELECTRICIAN

GENERAL

- Read all instructions carefully for safe operation and installation.
- All electrical connections must be in accordance with local and national electrical code (N.E.C) standards.
- Remove the fixture and the mounting package from the box and make sure that no parts are missing by referencing the illustrations on the installation instruction. Please contact Blackjack Lighting if any parts are missing or damaged.
- This product is suitable for damp locations.

INSTALLATION**PREPARATION**

1. Carefully remove the fixture from its box.
2. To remove the ceiling plate(10) from the canopy cover(11) first loosen the thumbscrew(12), then push the canopy cover(11) up and twist to the left.
3. Pull the supply wires(2&4) and house ground wire(6) from the outlet box(1).
4. If the pendant is disassembled slide the metal shade support(21) onto the cable(19) in between the socket and the metal shade(20). Then screw the light guide(22) into the socket.

ELECTRICAL CONNECTIONS

5. Using the wire connectors(8), connect the white supply wire(2) to the white fixture wire(3); connect the black supply wire(4) to the black fixture wire(5); and connect the house ground wire(6) to the fixture ground wire(7) .

MOUNTING

6. Once all the wires are connected carefully wind them up and secure them with the included twist ties. Then place them back into the outlet box(1). Secure the ceiling plate(10) to the outlet box(1) by sliding the mounting screws(9) through the holes in the ceiling plate(10) and screwing them into the outlet box(1). Secure the wiring barrier plate(14) to the canopy cover(11) with the included screws(17).

FINAL ASSEMBLY

7. Adjust the pendant cable(19) to the desired length. (if in doubt about exact length needed, leave a little extra cable until final installation of the canopy cover(11)). Push the excess cable(19) up into the canopy(11) by pressing the small barrel of the gripper(18) upward. This will release the wire tension and allow the suspended cable to be pulled through the gripper(18). Wind the excess cable around the u-bracket(16) located in the canopy cover(11). Wrap the supplied Velcro strap around this loop to keep the excess wire from falling outside of it. Then attach the low voltage power feed by plugging in the female connector(15) from the driver(13) to the male connector from the pendant cable(19).
8. Secure the canopy cover(11) to the ceiling plate(10) by first aligning the canopy(11) cut outs with the ceiling plate(10) tabs then pushing the canopy cover(11) up over the ceiling plate(10) and twisting to the right. Lastly secure them together with the thumbscrew(12).

DIMMING

- Fixture Dimming Type: TRIAC or ELV
- For recommended dimmers see <https://www.blackjacklighting.com/dimming-information>

HARDWARE

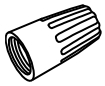

Wire Connectors(#8)
[3 Included]



Mounting Screws(#9)
[2 Included]



Thumb screw(#12)
[1 Included]



Screws(#17)
[2 Included]

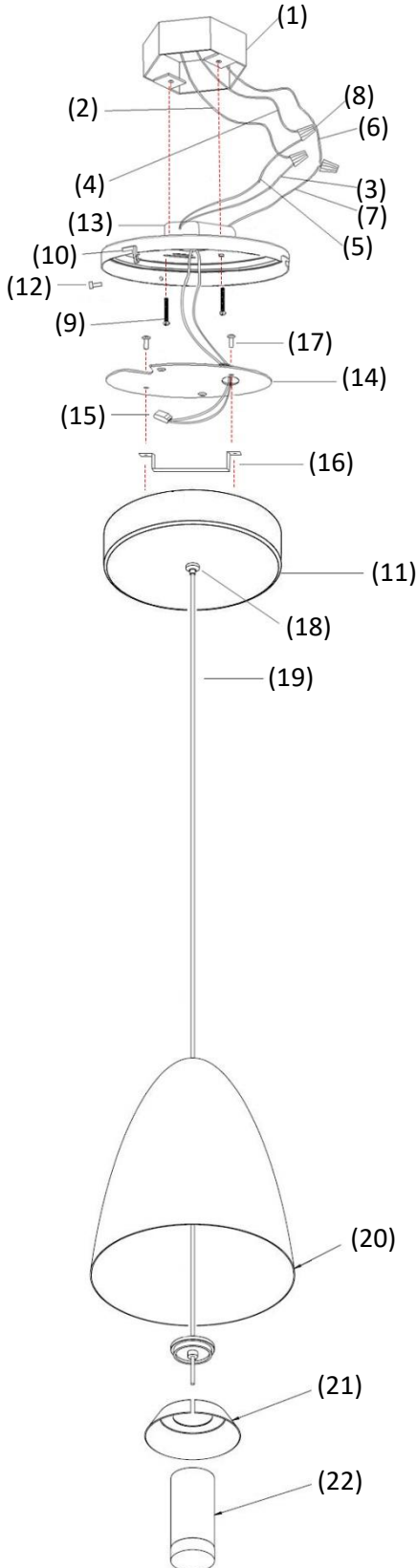

1. OUTLET BOX (By Others)
2. WHITE SUPPLY WIRE
3. WHITE FIXTURE WIRE
4. BLACK SUPPLY WIRE
5. BLACK FIXTURE WIRE
6. HOUSE GROUND WIRE
7. FIXTURE GROUND WIRE
8. WIRE CONNECTORS
9. MOUNTING SCREWS
10. CEILING PLATE
11. CANOPY COVER
12. THUMBSCREW
13. DRIVER
14. WIRE BARRIER PLATE
15. LOW VOLTAGE FEMALE CONNECTOR
16. U-BRACKET
17. SCREWS
18. GRIPPER
19. CABLE
20. METAL SHADE
21. METAL SHADE SUPPORT
22. LIGHT GUIDE